



Town Of Berlin

240 Kensington Road
Berlin, CT 06037
860-828-7036

Office of the Town Clerk

May 20, 2020

RESOLUTION

TO THE BERLIN PLANNING AND ZONING COMMISSION

I hereby certify the following to be a true and exact copy of a resolution adopted by the Town Council, for the Town of Berlin, at its duly called and held Regular Town Council meeting on May 19, 2020 at which a quorum was present and acting throughout, and that the resolution has not been modified, rescinded, or revoked and is at present in full force and effect:

“Refer the granting of the easements on a portion of 889 Farmington Avenue to 861 and 873 Farmington Avenue for a review by the Planning and Zoning Commission pursuant to section 8-24 of the Connecticut General Statutes.”

VOTE 7-0

MOTION CARRIED

IN WITNESS WHEREOF, I have set my hand and affixed the municipal seal of said municipality this 20th day of May 2020.

TOWN OF BERLIN, CONNECTICUT
OFFICE OF THE TOWN CLERK

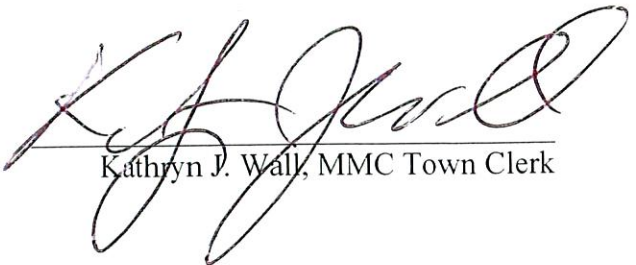

Kathryn J. Wall, MMC Town Clerk

Attachment (Map)

Agenda Item No. _____
Request for Town Council Action

TO: The Honorable Mayor and Town Council

FROM: Arosha Jayawickrema, Interim Town Manager

DATE: May 11, 2020

SUBJECT: Section 8-24 Referral to the Planning and Zoning Commission regarding easements from a portion of 889 Farmington Avenue to 861 and 873 Farmington Avenue

Summary of Agenda Item:

The Town of Berlin owns 861 and 889 Farmington Avenue and has a contract to sell these properties to Newport Realty Group LLC. Staff has been working with the 873 Farmington Avenue property owner and Newport Realty Group LLC to devise a combined 861, 873 Farmington Avenue site plan related to potential resolution of the zoning appeal related to the Steele Center @ Farmington Ave project at 861, 889, 903 and 913. In order to increase the amount of available parking on the sites, parking and maintenance easements are proposed for a narrow strip of property along the south border of 889 Farmington Avenue. Granting these easements will allow perpendicular parking along the north property side of 861 and 873 Farmington Avenue thus increasing the number of spaces that can be created and supporting enhanced development of these sites. Before the Town Council can act on the granting of the easements it needs to refer the granting of the easements on a portion of 889 Farmington Avenue to 861 and 873 Farmington Avenue for a review by the Planning and Zoning Commission pursuant to section 8-24 of the Connecticut General Statutes.

Action

Move to refer the granting of the easements on a portion of 889 Farmington Avenue to 861 and 873 Farmington Avenue for a review by the Planning and Zoning Commission pursuant to section 8-24 of the Connecticut General Statutes.

Attachments:

1. Map showing easement area.

Prepared By:

Chris Edge, Economic Development Director
Jim Mahoney, Economic Development Coordinator

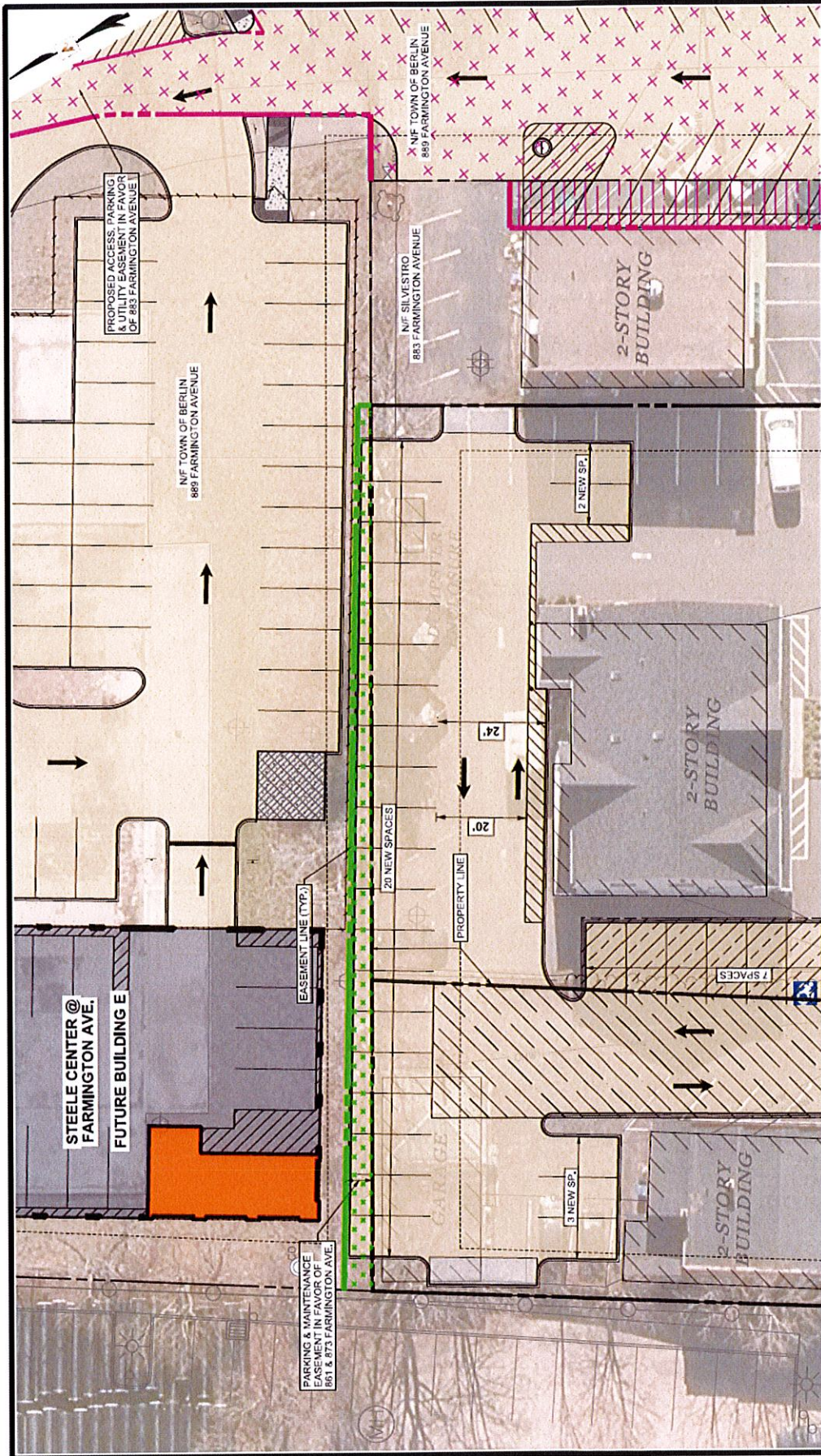

SCALE: 1" = 20'
 PROJECT NO. 50060 - 00001
 SHEET NO. 889 01
 DATE: 5/12/20

CONTACT INFORMATION
 VANDERHART ASSOCIATES, LLC
 191 SORBITCH AVENUE
 LERAMON, CONNECTICUT
 Phone: (860) 367-7244
 Fax: (860) 367-7244
 www.vanderhartassoc.com

STEELE CENTER @ FARMINGTON AVENUE
 PREPARED FOR TOWN OF BERLIN
PROPOSED 889 FARMINGTON AVENUE EASEMENTS
 BERLIN, CT
 861, 874, AND FARMINGTON AVENUE